

# Wisconsin Science Olympiad

## School of Architecture and Urban Planning First Floor Events

### Division B:

B1: Mission Possible: SARUP Commons

↑ North

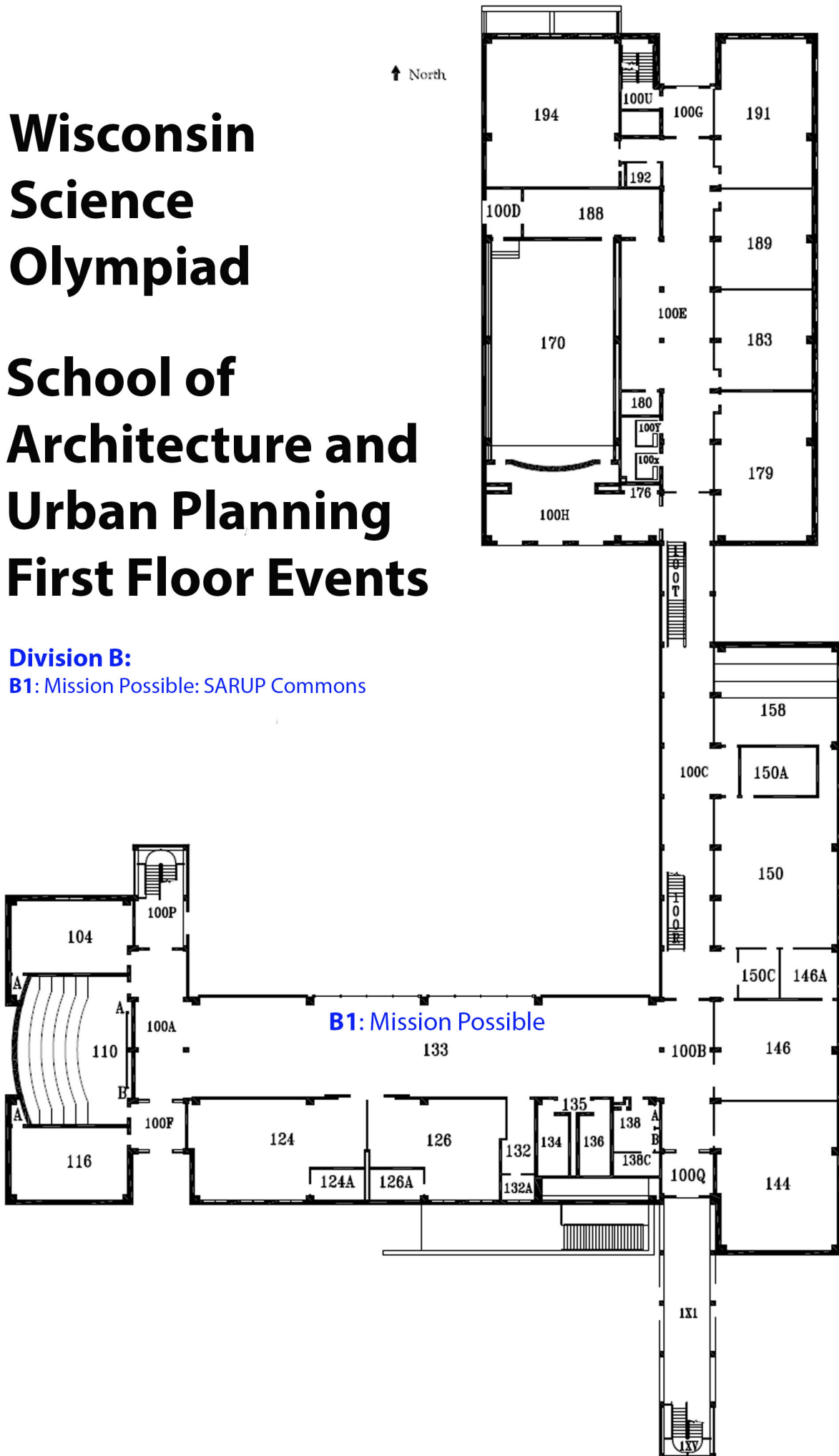

# Wisconsin Science Olympiad

## Bolton Hall Basement Events

**Division C:**  
**C1: Robot Arm: BOL B52**

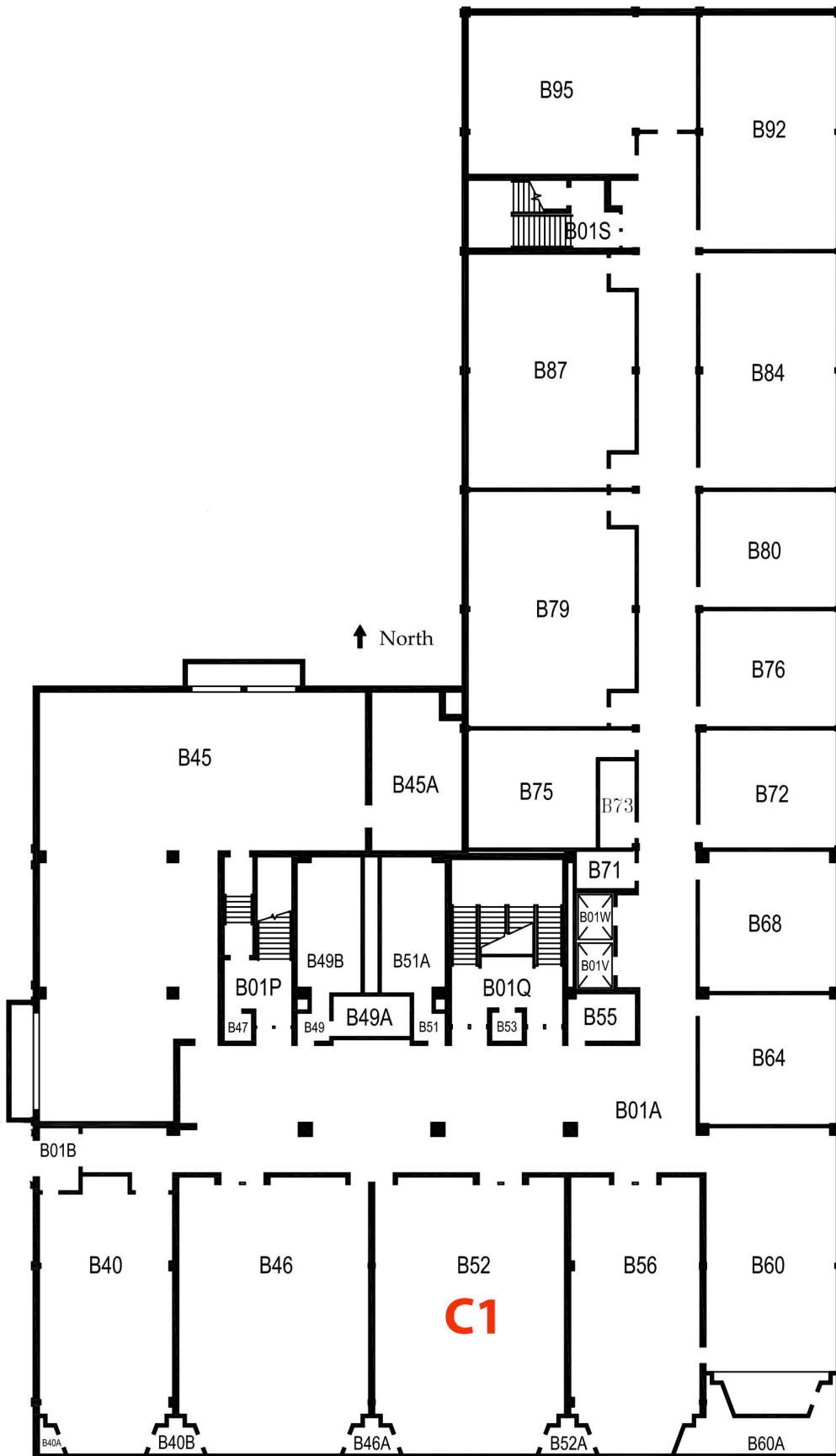

# Wisconsin Science Olympiad

## Bolton Hall First Floor Events

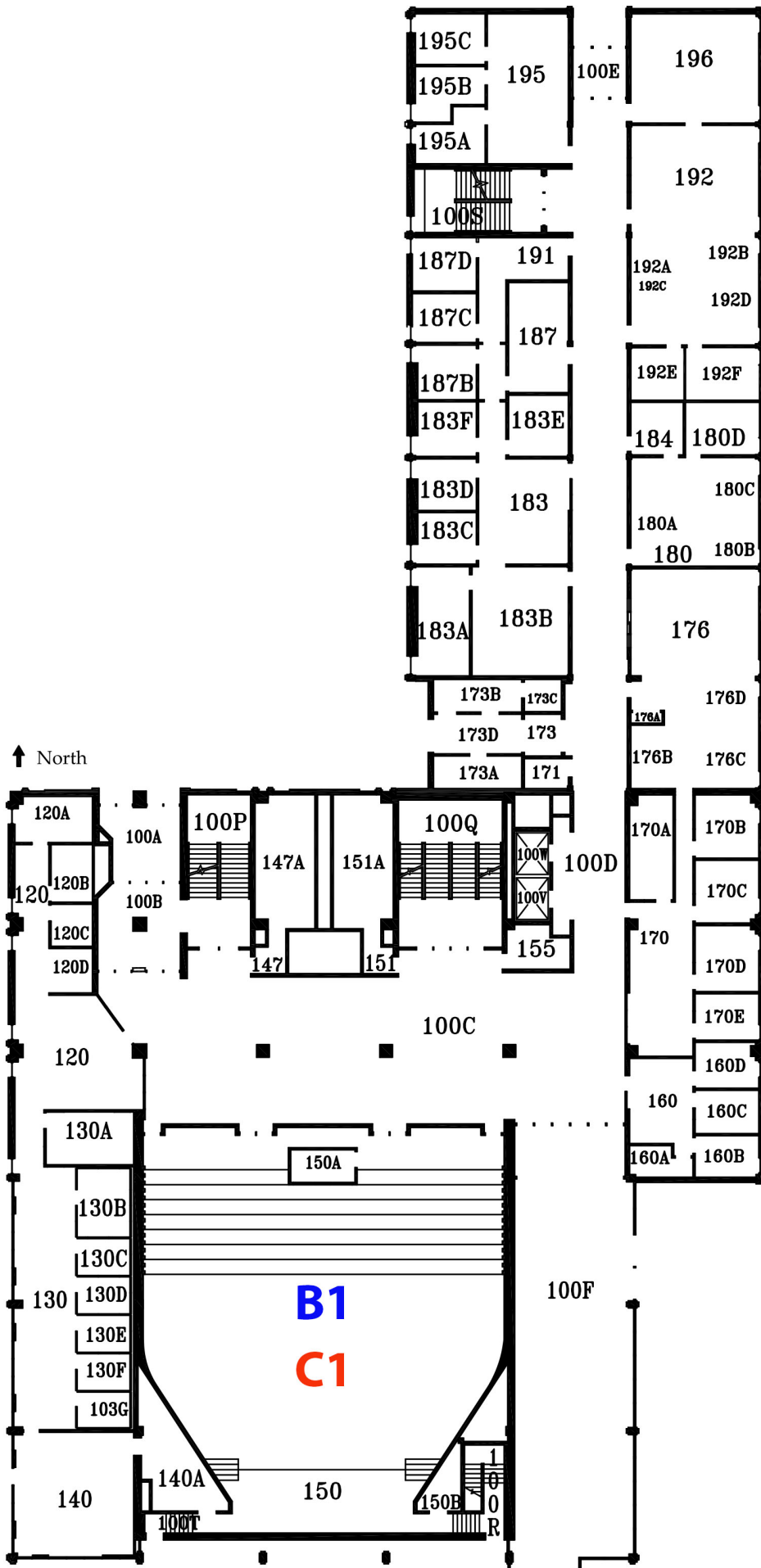

**Division B:**

**B1:** Disease Detectives: BOL 150

**Division C:**

**C1:** Disease Detectives: BOL 150



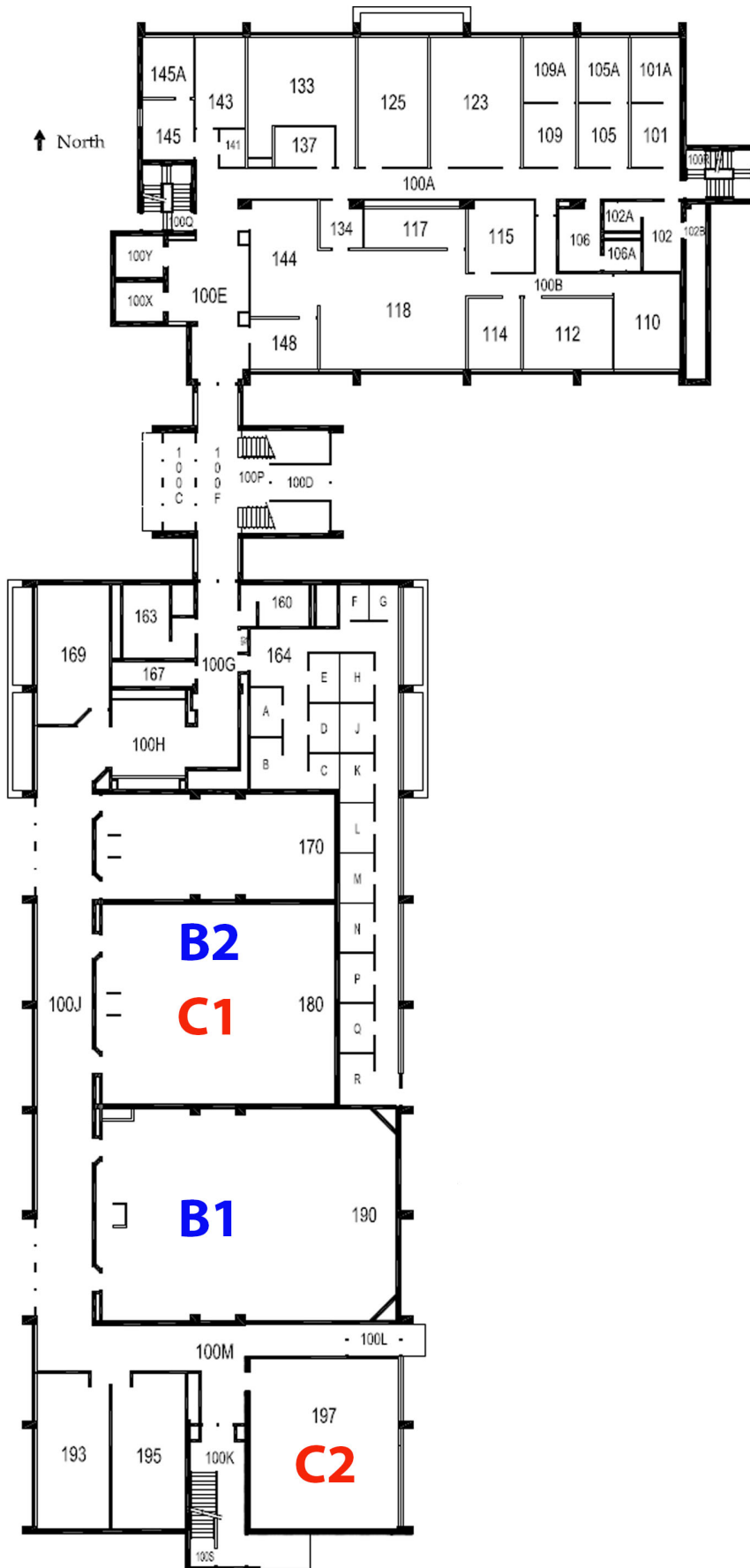

# Wisconsin Science Olympiad

## Chemistry Building First Floor Events

### Division B:

**B1:** Reach for the Stars: CHM 190

**B2:** Dynamic Planet: CHM 180

### Division C:

**C1:** Dynamic Planet: CHM 180

**C2:** Code Busters: CHM 197





# Wisconsin Science Olympiad

## Chemistry Building Second Floor Events

### Division B:

Experimental Design: CHM 297  
 Food Science: CHM 286

### Division C:

Sustainable Energy: CHM 271  
 Experimental Design: CHM 285  
 Food Science: CHM 298



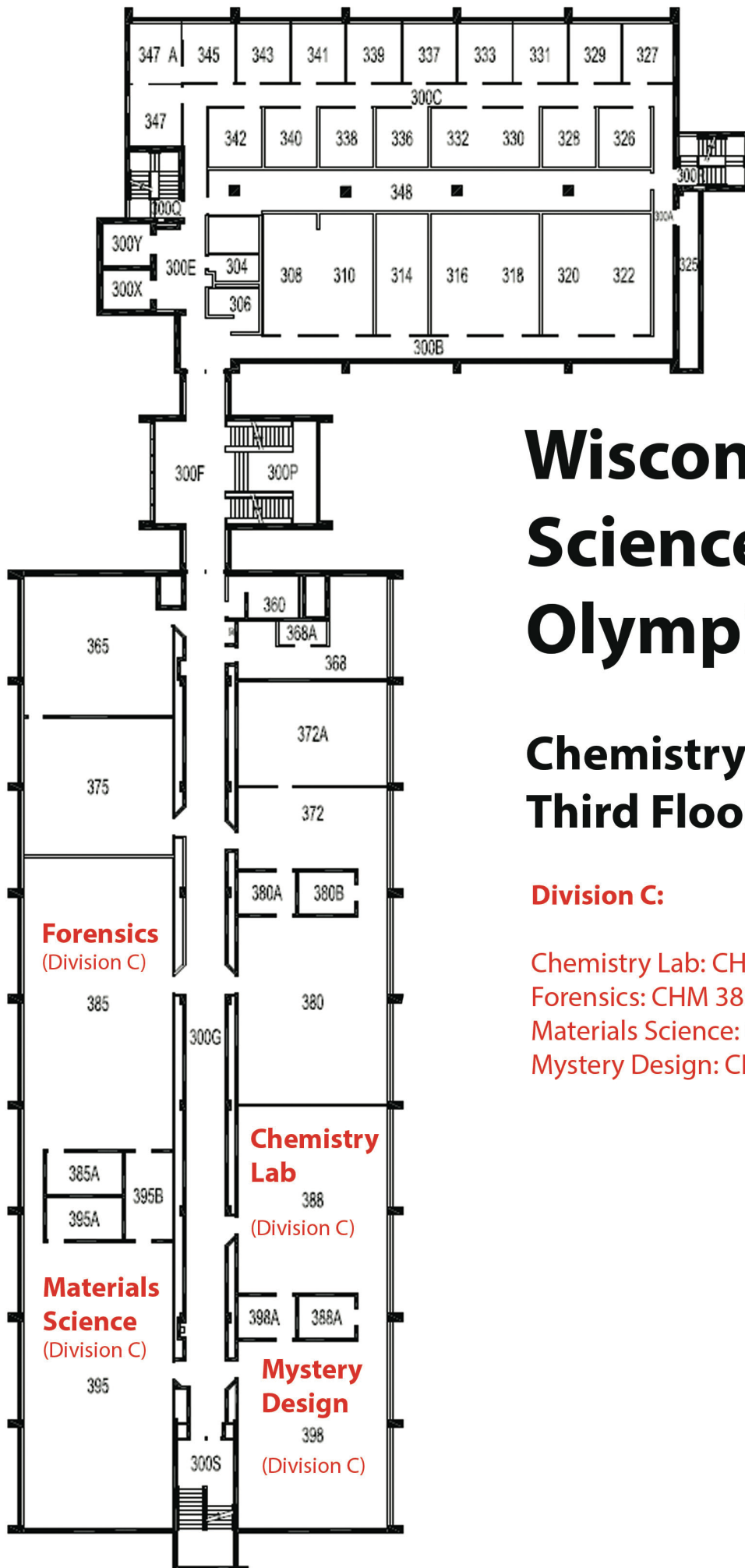

# Wisconsin Science Olympiad

## Chemistry Building Third Floor Events

### Division C:

- Chemistry Lab: CHM 388
- Forensics: CHM 385
- Materials Science: CHM 395
- Mystery Design: CHM 398

**Forensics**  
 (Division C)

**Chemistry  
 Lab**  
 (Division C)

**Materials  
 Science**  
 (Division C)

**Mystery  
 Design**  
 (Division C)



→ North

# Wisconsin Science Olympiad

## Engineering & Mathematical Sciences Building First Floor Events

### Division B:

**B1:** Optics: EMS E159/160/169/170

**B2:** Road Scholar: EMS E145

### Division C:

**C1:** Optics: EMS E159/160/169/170

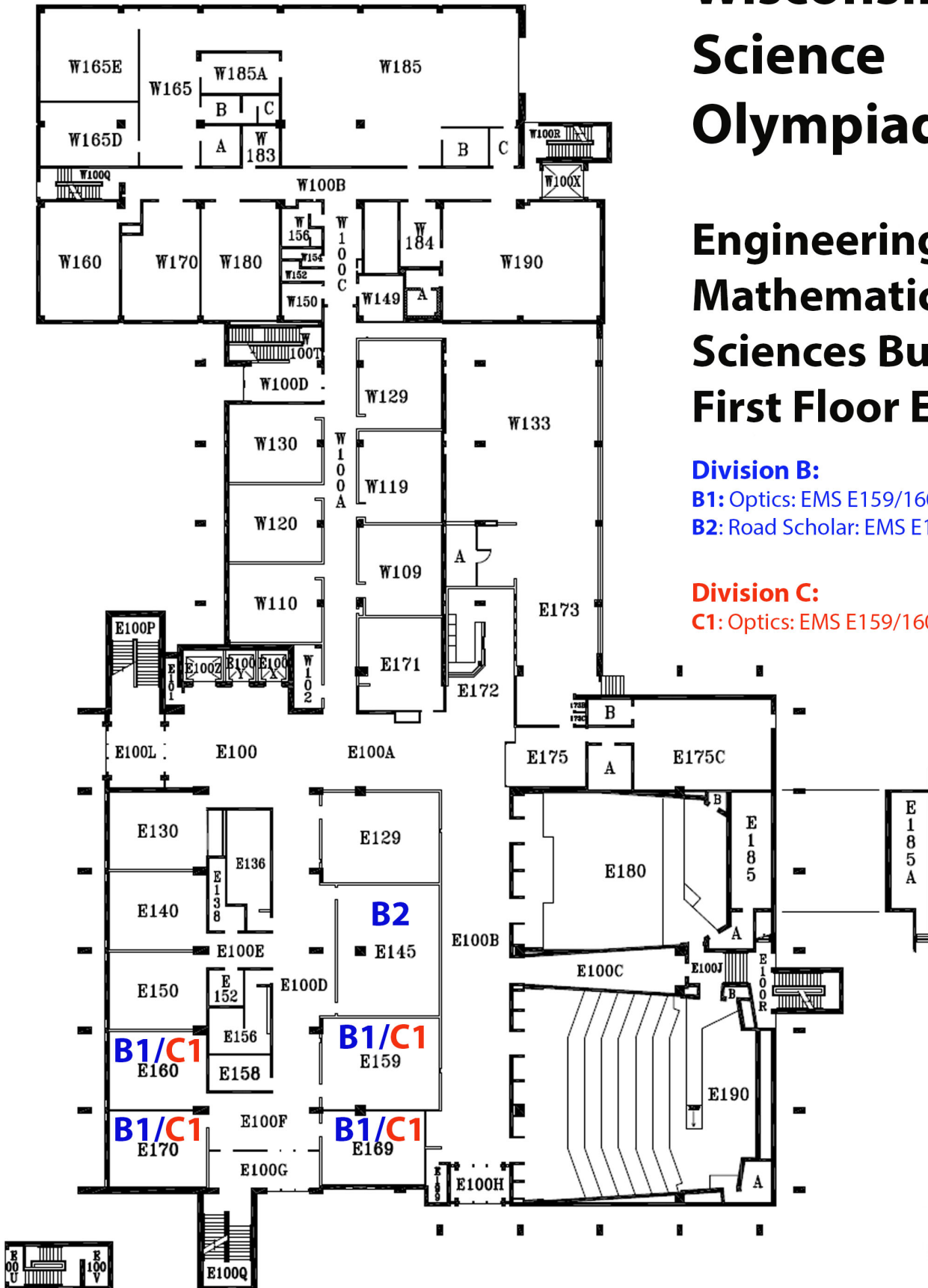

# Wisconsin Science Olympiad

## Engineering & Mathematical Sciences Building Fourth Floor Events

### Division C:

**C1:** Hydrogeology: EMS E423

**C2:** Game-On: EMS E425

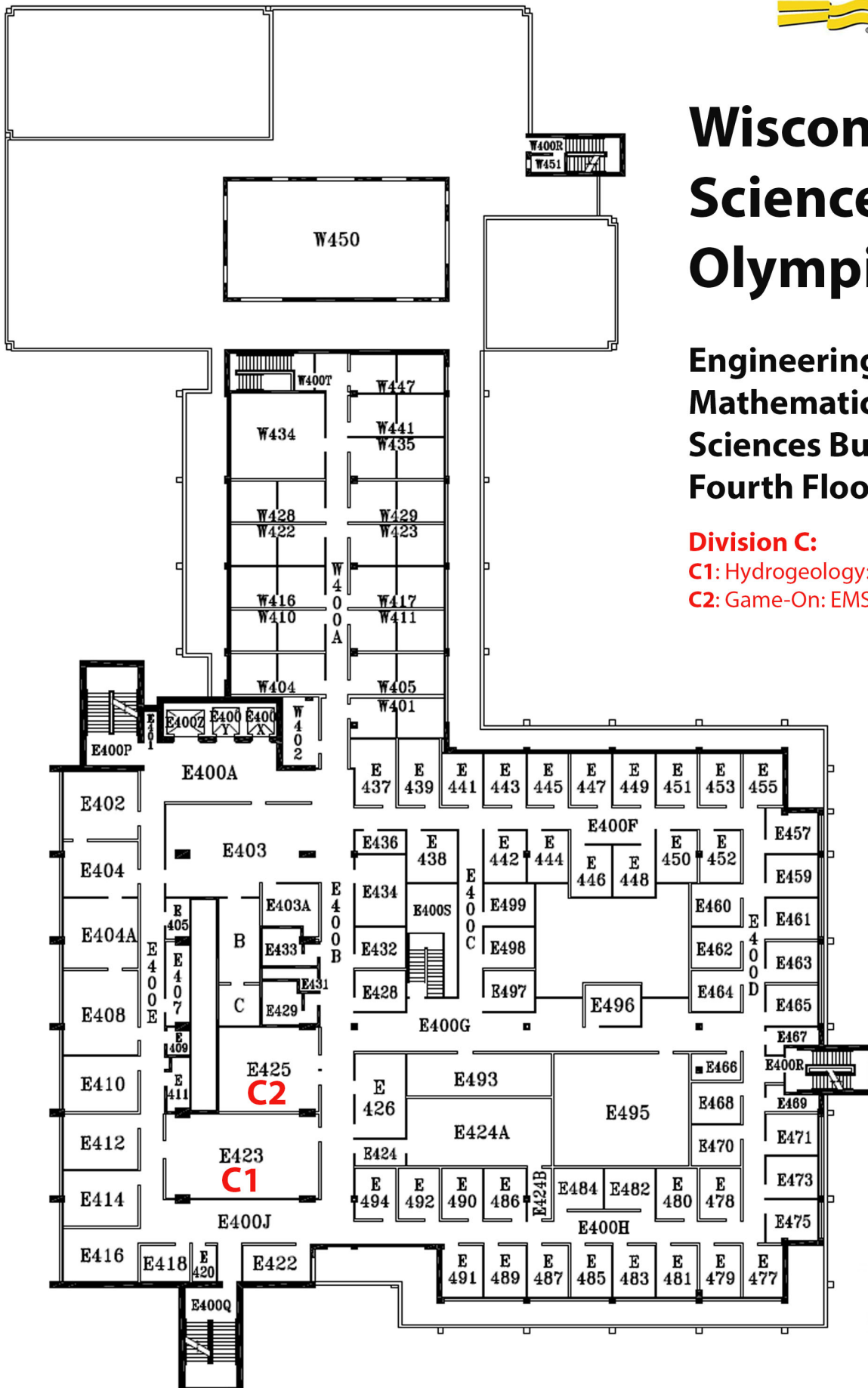



# Wisconsin Science Olympiad

## Engelmann Hall First Floor Events

### Division B:

- B1:** Towers: ENG 105
- B2:** Wright Stuff: ENG 199 (Gym)

### Division C:

- C1:** Towers: ENG 105
- C2:** Helicopters: ENG 199 (Gym)
- C3:** WIFI Lab: ENG 199 (Gym)

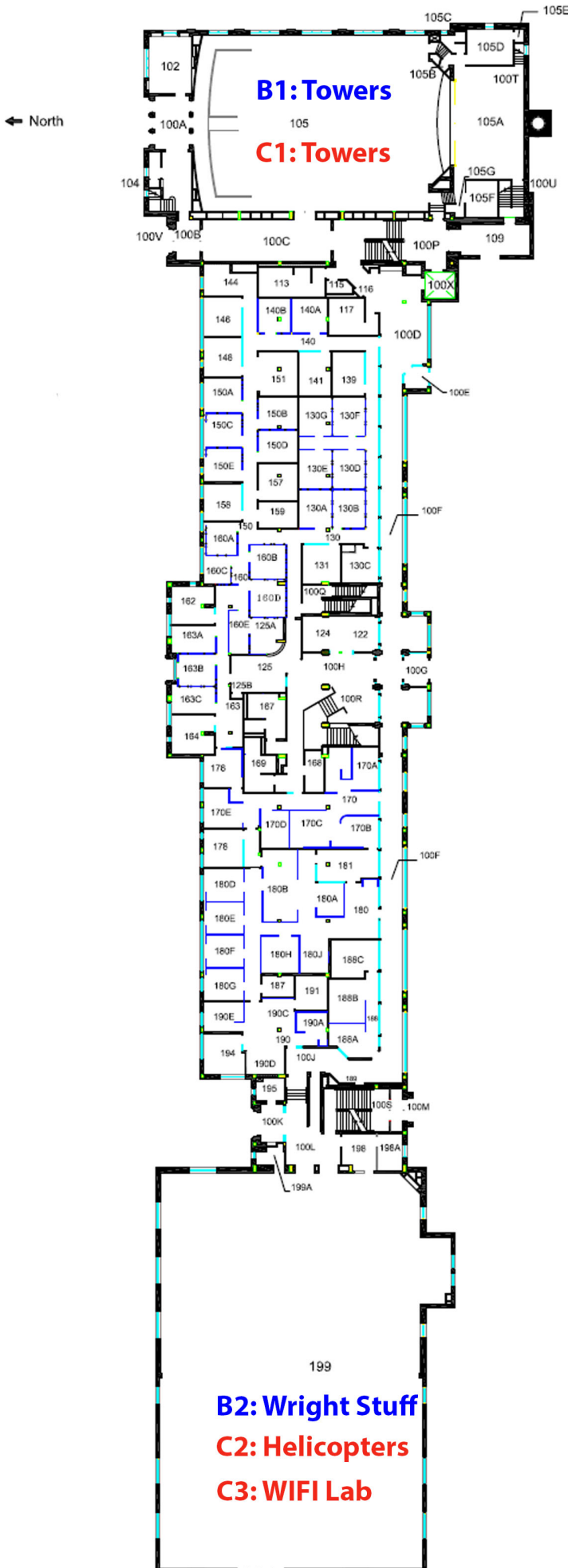

# Wisconsin Science Olympiad

# Kenwood Interdisciplinary Research Complex First Floor Events



**Division B:**

- B1:** Write It, Do It: KIRC 1130-1160
- B2:** Fast Facts (Scattogories): KIRC 1180
- B3:** Bottle Rocket: KIRC Lawn

**Division C:**

- C1:** Write It, Do It: KIRC 1130-1160

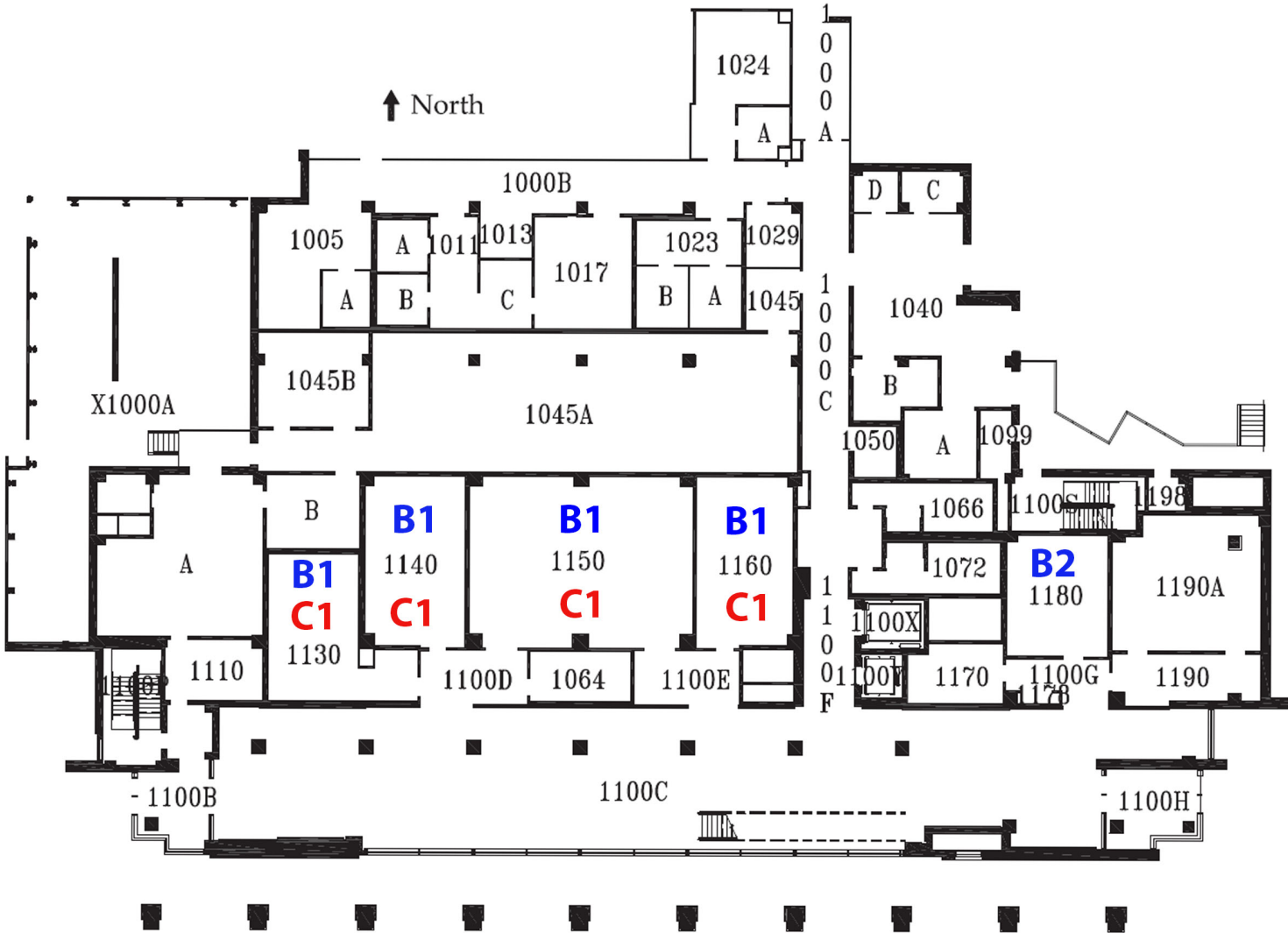

**B3: Bottle Rocket**  
(KIRC Lawn)





# Wisconsin Science Olympiad

## Lapham Hall First Floor Events

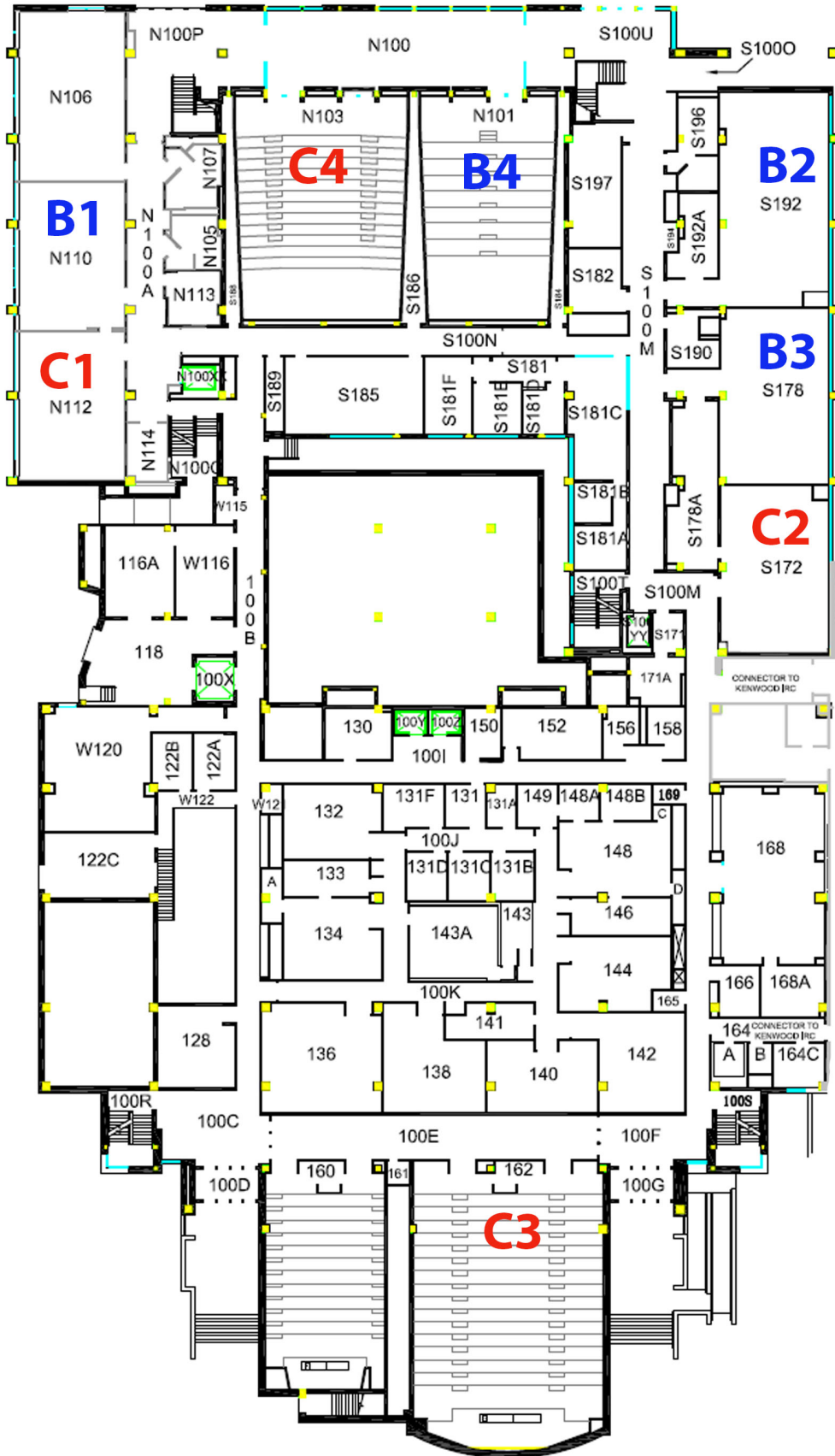

- Division B:**  
**B1:** Anatomy and Physiology: LAP N110  
**B2:** Crime Busters: LAP 192  
**B3:** Microbe Mission: LAP S178  
**B4:** Wind Power: LAP N101
- Division C:**  
**C1:** Anatomy and Physiology: LAP N112  
**C2:** Microbe Mission: S172  
**C3:** Astronomy: LAP 162  
**C4:** Wind Power: LAP N103

← North

# Wisconsin Science Olympiad

## Lapham Hall Second Floor Events

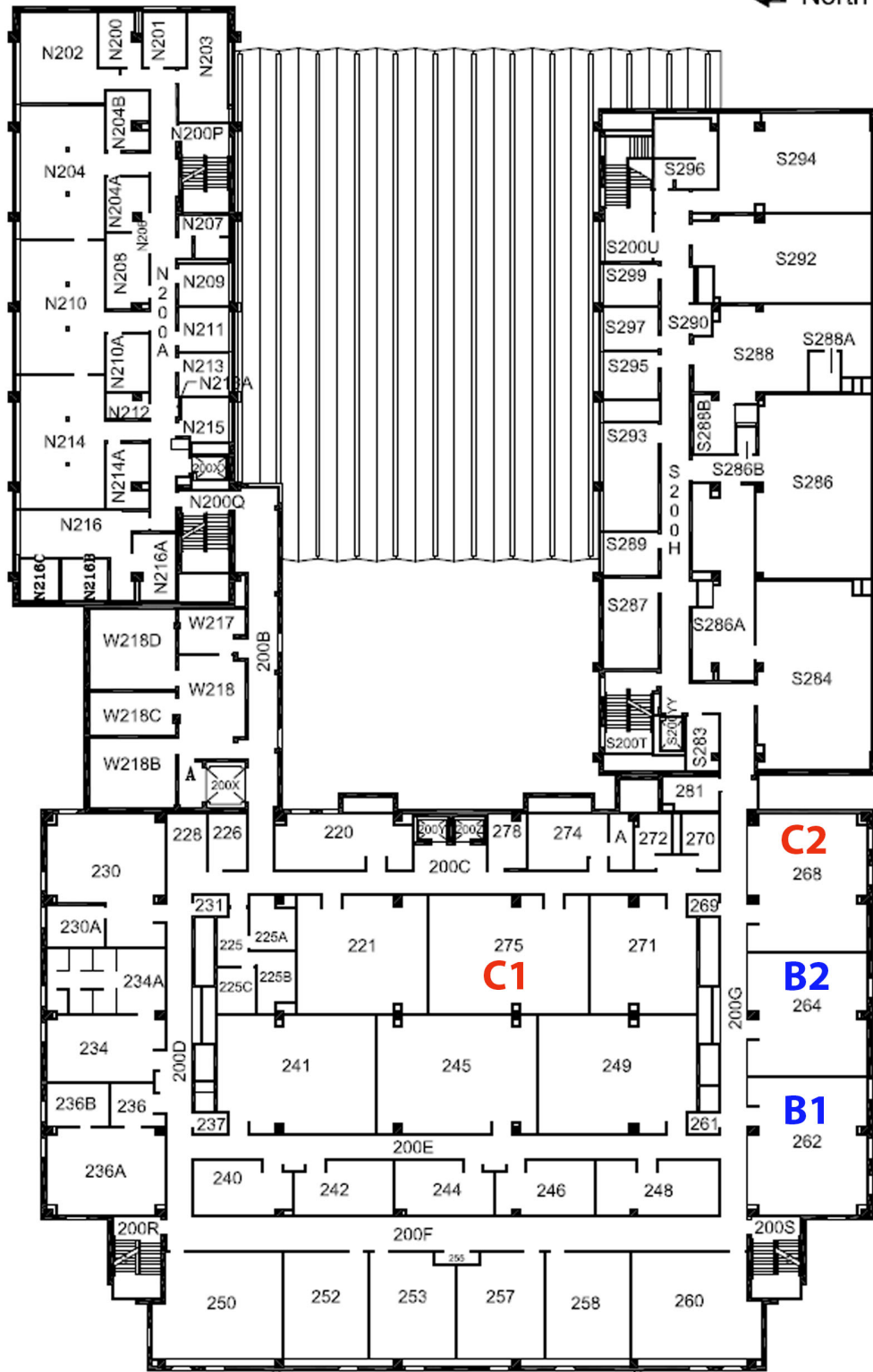

### Division B:

**B1:** Ecology: LAP 262

**B2:** Rocks and Minerals: LAP S264

### Division C:

**C1:** Ecology: LAP 275

**C2:** Rocks and Minerals: LAP S264

→ North

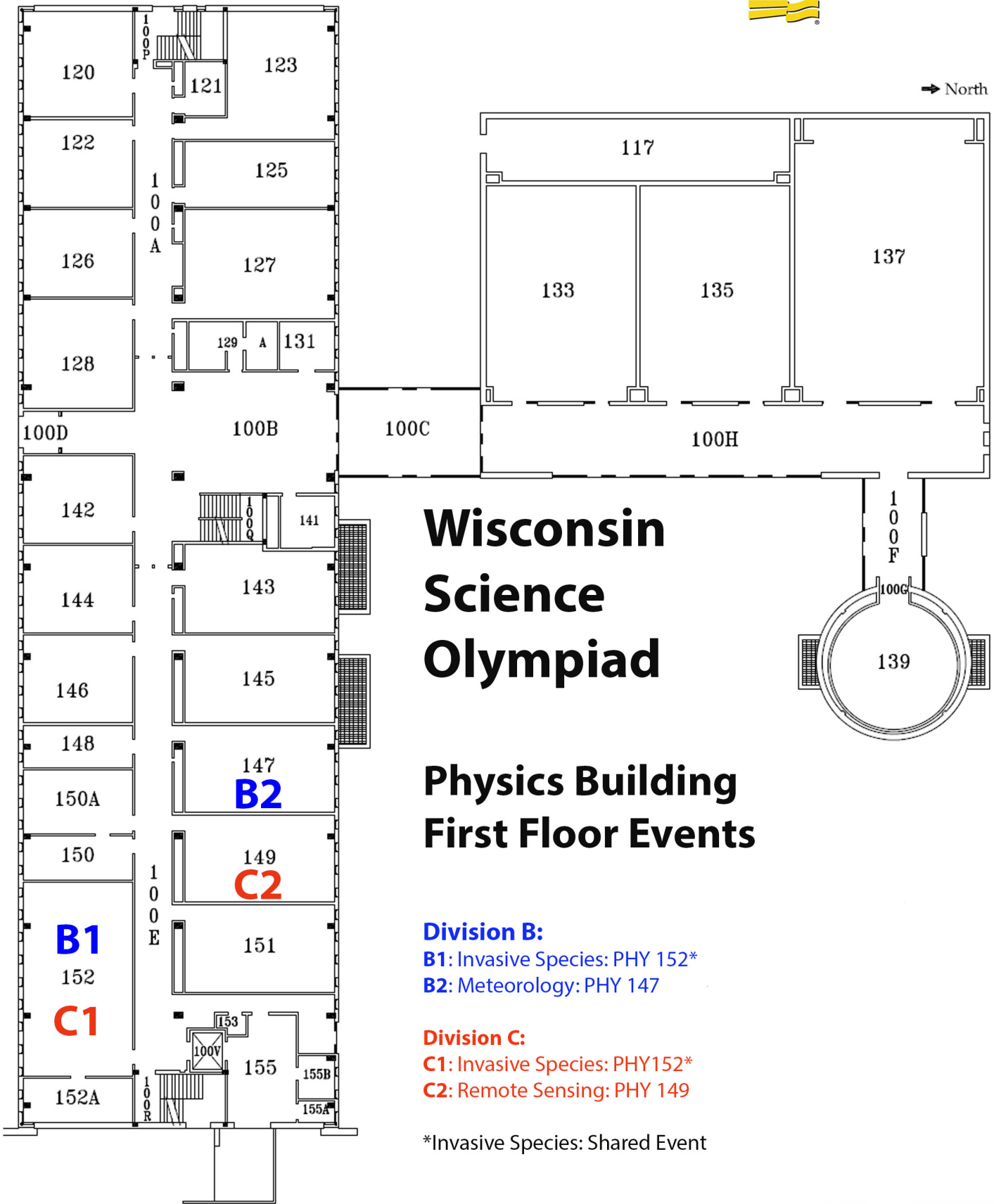

# Wisconsin Science Olympiad

## Physics Building First Floor Events

### Division B:

**B1:** Invasive Species: PHY 152\*

**B2:** Meteorology: PHY 147

### Division C:

**C1:** Invasive Species: PHY 152\*

**C2:** Remote Sensing: PHY 149

\*Invasive Species: Shared Event

# Wisconsin Science Olympiad

## Union Ground Floor Events

### Division B:

**B1:** Scrambler: Union Concourse

### Division C:

**C1:** Electric Vehicle: Union Concourse



# Wisconsin Science Olympiad

## Union Second Floor Evnts

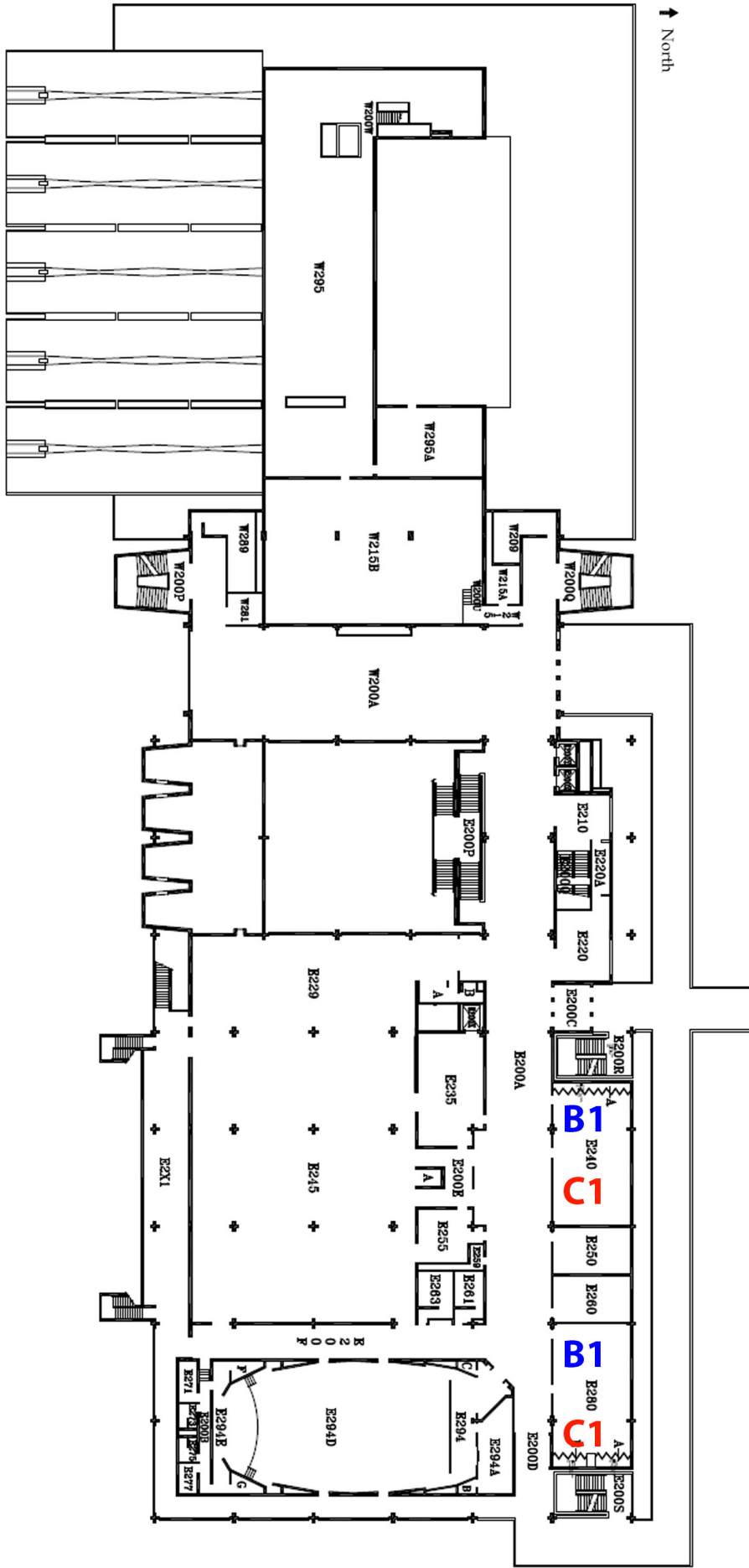

**Division B:**  
 B1: Hovercraft: UN 240 & 280

**Division C:**  
 C1: Hovercraft: UN 240 & 280